

7450 Series

Side plate style meters with 75 mm or 150 mm borosilicate glass tube and 316L stainless steel or brass connections. Valves optional. Also available with PVC ends and Hastelloy® C-276 construction for greater chemical resistance

Description

Metering Tube

Borosilicate Glass

Internal Components

316L Stainless Steel

Inlet/Outlet Fittings

FNPT, Horizontal
Control Valve optional

Fitting Material

Brass or 316L Stainless Steel

Elastomers

Standard: Viton®
Optional: Buna N, EPR, and Kalrez®

Options

Certified Calibrations

Conform to ISA RP 16.6

Scales

Can be produced in any volumetric unit



Glass Tube

Performance

Capacities

.48 to 7.4 GPM — Water
2 to 20 SCFM — Air

Scale

75 mm (3"), 150 mm (6")
Direct reading, detachable

Accuracy

± 5% of Full Scale Flow, 75 mm
± 3% of Full Scale Flow, 150 mm

Turndown

10:1 to 12.5:1, unless otherwise indicated

Repeatability

1%

Max Temperature

200°F (93°C)

Max Pressure

200 psig

Ambient Temperature

33°F to 125°F (1°C to 52°C)

Refer to specification table on page 21

Connection Size

3/8" FNPT

Float Types:



Maximum Viscosity Compensation



Lowest Pressure Loss

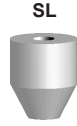

Maximum Flow

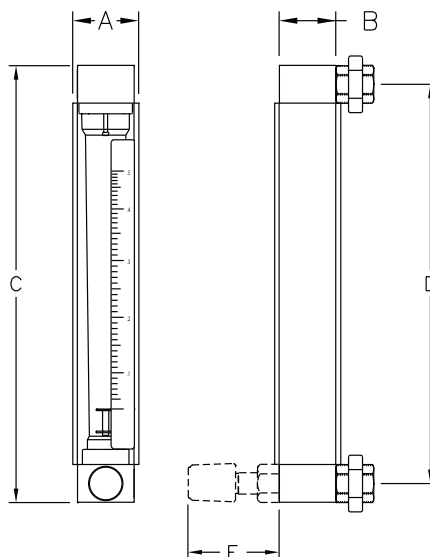

Specifications:

75mm Scale Models													
Order Number	Full Scale Flow				Float Number	Float Type	Tube Size	Tube Number	Dimensions (Inches)				
	Water		Air						A	B	C	D	E
	GPM	LPM	SCFM	SLPM									
3G1	.48	1.8	2.0	56	1/2-LPG-04	LP	.50"	1/2-24-G-3	1.75	1.50	8.00	7.00	2.25
3G2	1.0	3.8	4.0	112	1/2-LPG-05	LP	.50"	1/2-24-G-3	1.75	1.50	8.00	7.00	2.25
3G3	2.0	7.6	8.2	230	1/2-SLG-01	SL	.50"	1/2-24-G-3	1.75	1.50	8.00	7.00	2.25
3P1	2.5	9.4	10.0	280	5/8-GVP-01	GV	.625"	5/8-29-P-3	1.75	1.50	8.00	7.00	2.25
3P2	4.0	15.0	20.0	560	5/8-SLP-01	SL	.625"	5/8-29-P-3	1.75	1.50	8.00	7.00	2.25
3P3	5.6	21.0	—	—	5/8-SLP-02	SL	.625"	5/8-29-P-3	1.75	1.50	8.00	7.00	2.25
3P4	7.4	28.0	—	—	5/8-SLP-03	SL	.625"	5/8-29-P-3	1.75	1.50	8.00	7.00	2.25

150mm Scale Models													
Order Number	Full Scale Flow				Float Number	Float Type	Tube Size	Tube Number	Dimensions (Inches)				
	Water		Air						A	B	C	D	E
	GPM	LPM	SCFM	SLPM									
6G1	0.5	1.9	2.0	57	1/2-LPG-04	LP	.50"	1/2-24-G-6	1.75	1.50	11.56	10.56	2.25
6G2	1.0	3.8	4.2	118	1/2-LPG-05	LP	.50"	1/2-24-G-6	1.75	1.50	11.56	10.56	2.25
6G3	2.0	7.6	8.2	230	1/2-SLG-01	SL	.50"	1/2-24-G-6	1.75	1.50	11.56	10.56	2.25
6P1	2.5	9.4	10.0	280	5/8-GVP-02	GV	.625"	5/8-32-P-6	1.75	1.50	11.56	10.56	2.25
6P2	4.0	15.0	20.0	560	5/8-SLP-04	SL	.625"	5/8-32-P-6	1.75	1.50	11.56	10.56	2.25
6P3	5.6	21.0	—	—	5/8-SLP-05	SL	.625"	5/8-32-P-6	1.75	1.50	11.56	10.56	2.25
6P4	7.4	28.0	—	—	5/8-SLP-06	SL	.625"	5/8-32-P-6	1.75	1.50	11.56	10.56	2.25



King Instrument Company manufactures borosilicate glass metering tubes. These are used exclusively in all Kinglass models.



Ordering:

Use the following guide to determine the specific product number you require.

Meter Series	Order Number	Fitting Material	O-ring Material	Scale	Valve Option
7 4 5	See Specifications Table	Brass - 1 316L SS - 2	EPR - 1 Buna-N - 2 Viton® - 3 Kalrez® With No Valve - 4 Kalrez® With Valve - 5	Millimeter - 1 GPM Water@70°F - 2 LPM Water@70°F - 3 SCFM Air@STP - 4 SLPM Air@STP - 5 Non standard - 6	Brass - Inlet - 1 Brass - Outlet - 2 No Valve - 3 316L SS - Inlet - 4 316L SS - Outlet - 5

Example: 745 - 6P4 - 2 - 3 - 2 - 1